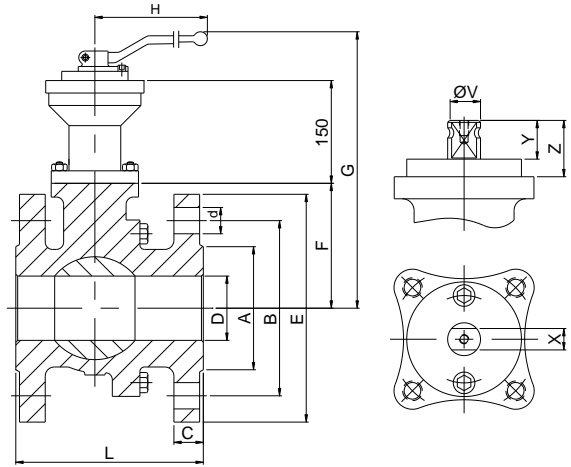
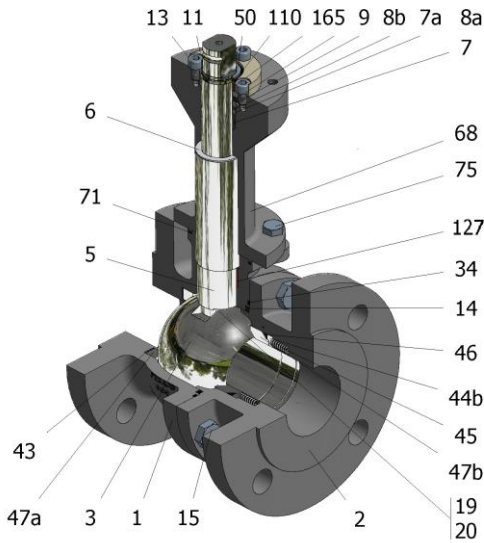

FIG.ZFMS 14 CGGG CL150 1/2"-8"



Position	Description	Material
01	Body 1	C.S. A216 WCC
02	Body 2	C.S. A216 WCC
03	Ball	S.S. CF8M+Cr-Carbide
05	Stem	XM-19
06	Stem seal	S.S. AISI 316 Nitrided
07	Stem packing	Graphite
07a	Stem packing 2	Graphite
08a	Gland packing 1	S.S. AISI 316
08b	Gland packing 2	S.S. AISI 316
09	Spring washer	Inconel X718
11	Cover	S.S. A351 CF8M
13	Cover bolt	S.S. (316)
14	Body seal 1	Graphite
15	Body bolt	A193 B7M
16	Handle	WCB
17	Handle bolt	1.045(8.8)
19	Spring	S.S. AISI 316
20	Antistatic ball	S.S. AISI 316
31	Bearing	Carbongraphite
34	Body seal 2	Graphite
43	Seat seal	Graphite
44b	Ring seat 2	S.S. AISI 316
45	Spring seat	Inconel X750
46	Seat seal	Graphite
47	Metal seat	AISI 316+Cr-Carbide
50	Subjection ring	S.S. AISI 420
68	Stem extension casing	C.S. A350 LF2/A-105
71	Extension seal	Graphite
75	Extension bolt	S.S. (316)
110	Subjection ring seal	S.S. AISI 316 Nitrided
165	Stem bearing	Carbongraphite

General features

- Floating ball.
- Split body.
- Full bore.
- Metal to Metal.
- Bidirectional.
- Spring loaded seat system.
- Anti Blow out proof stem.
- Autoadjustable packing.
- Anti static device.
- Self-cavity pressure relief.
- Security stem extension

Standards

- Top flange ISO 5211
- Flanges ANSI B16.5
- Face to face ANSI B16.10
- Design API 6D, B16.34
- Bidirectional.
- Testing API 598, API 6D, BS 6755-1
- Materials according to NACE MR0175

Official approvals

- CERTIFICATE FIRE SAFE
- TA-LUFT VDI 2440
- ISO 15848-1
- API 6D.
- ATEX 2014/34/EU
- PED 2014/68/EU
- SIL 3 CAPABLE

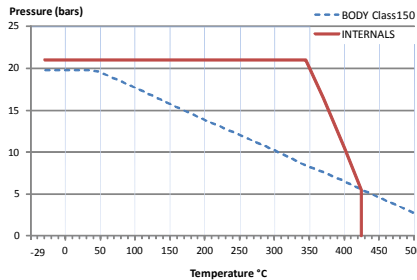

PEKOS GROUP CERTIFICATES:
ISO 9001-2008 / 2014/68/EU /API-6D



DIMENSIONS & Technical information

DN	CL	D	L	E	A	B	C	F	H	G	V	X	Y	Z	n x d	ISO 5211	Torque	MAST	Weight
1/2"	150	15	108	90	35	60	11	45	185	256	14	11	11	14	4 x 16	F05	35	81	3
3/4"	150	20	117	100	43	70	12	47	185	258	14	11	11	14	4 x 16	F05	51	81	4
1"	150	25	127	110	51	79	14	52	185	263	18	14	17	20	4 x 16	F05	64	175	5
1 1/2"	150	40	165	125	73	98	16	75	293	295	22	17	20	30	4 x 16	F07	128	464	10
2"	150	50	178	150	92	121	17	83	293	303	22	17	20	30	4 x 19	F07	170	464	14
2 1/2"	150	65	190	180	105	140	19	96	293	316	22	17	20	30	4 x 19	F07	288	464	22
3"	150	80	203	190	127	152	21	113	450	349	28	22	22	40	4 x 19	F10	480	969	29
4"	150	100	229	230	157	191	25	128	450	371	28	22	22	40	8 x 19	F10	576	969	40
6"	150	150	394	280	216	241	27	176	740	435	36	27	35	50	8 x 22	F12	2240	1990	104
8"	150	200	457	345	270	299	30	245	750	504	48	36	40	63	8 x 22	F14	1900	4716	183

** Depending on service conditions.

* Dimensions are in mm.

* Torque & MAST are in Nm

* Weight is in Kilograms

* Torque values have been measured ΔP at maximum rating at room temperature